

# Motorized / Smart Drapes Belt Driven Instruction Manual

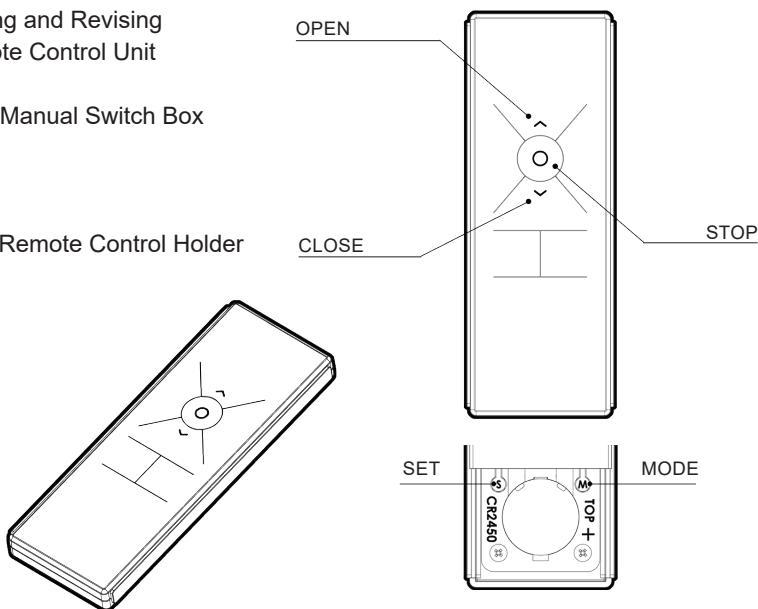

## Table of Contents

- 1-1 Travel Distance Setting and Revising
- 2-1 Adding another Remote Control Unit
- 3-1 Clear off Password
- 4-1 Externally connected Manual Switch Box
- 5-1 Battery Replacement
- 5-2 Product Specification
- 5-3 Quick Setting Index
- 5-4 Instructions for using Remote Control Holder



## How to open Battery Compartment Cover

△ Push the cover out

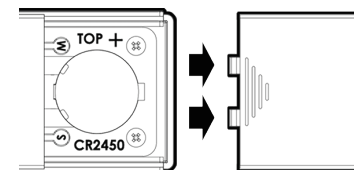

## How to replace Battery Compartment Cover

- 1 Insert latches into corresponding slots
- 2 Place Battery Compartment Cover to engage it with Slides
- 3 Push the cover in

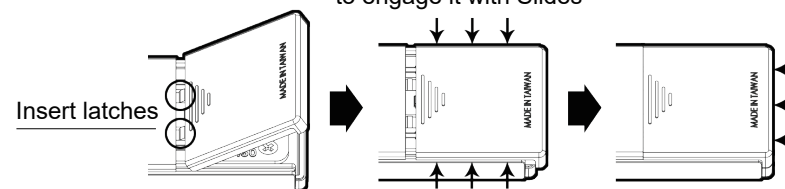

## 1-1 Travel Distance Setting and Revising

**STEP-1** STEP-1 Press [OPEN] + [SET] keys until a short beep sound occurs.

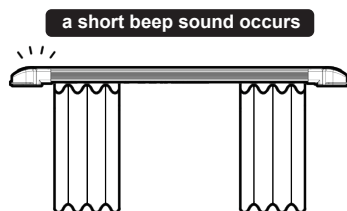
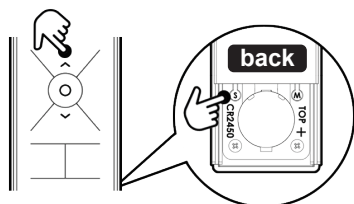

the Drape begins to set the travel distance automatically

steps:

the Drape opens completely

the Drape closes completely in 2 seconds

A long beep sound will occur, indicating that the travel distance setting is completed.

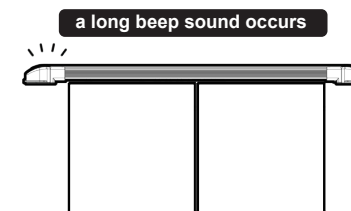

**Setting Completed**

Please repeat step 1-1 if there is something wrong with the travel distance of the Drape.



## 2-1 Adding another Remote Control Unit

**STEP-1** Press and hold [SET] until three short beep sounds occur, indicating that the setting mode of Adding another Remote Control Unit is activated.

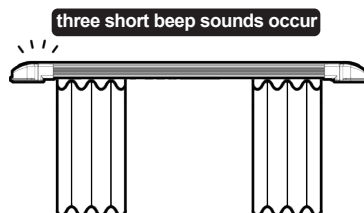
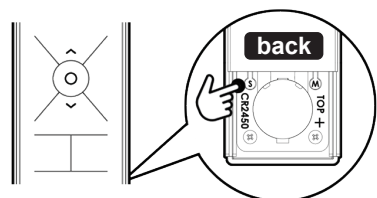

**STEP-2** Now press [STOP] key of the Remote Control to be added; the adding process is completed when a short beep sound occurs.

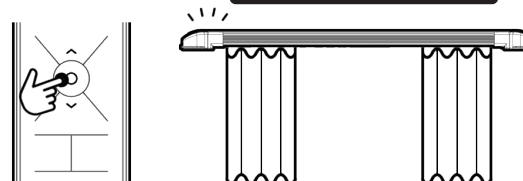

**Setting Completed**

After the setting is completed, a long beep sound will occur, indicating that the setting mode is deactivated.

## 3-1 Clear off Password

**STEP-1** Unplug power supply of the Motor, wait for 15 seconds, resume power supply of it. Within 8 seconds, press [OPEN] + [STOP] + [CLOSE] + any of blank keys [LEFT] OR [RIGHT] altogether 4 keys, beep sounds will occur immediately, then, within 5 seconds, press and hold [OPEN] + [CLOSE]. A long beep sound will then occur, indicating that the Password is cleared off.

unplug power supply → wait for 15 seconds → resume power supply → press 4 keys altogether within 8 seconds → beep sounds occur → press [OPEN] + [CLOSE] within 5 seconds → A long beep sound occurs and then stops

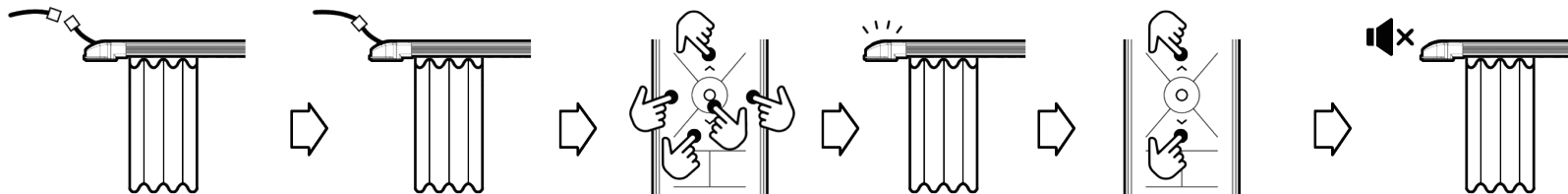

**Setting Completed**

When everything is done, only the password of this remote remains, others will be erased. If a new password is not added, the old password will not be erased.



## 4-1 Externally connected Manual Switch Box

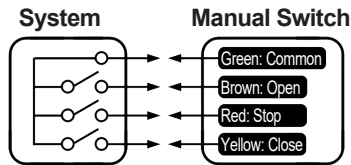
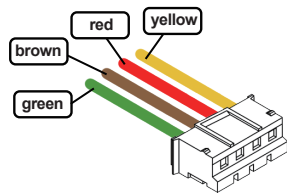

A brief contact will activate the function;  
DO NOT short-circuit continuously.

### Instructions

- Green + Brown** = open the Drape
- Green + Yellow** = close the Drape
- Green + Red** = stop the Drape

## 5-1 Battery Replacement

- 1 With flat side (positive +) of the Battery facing upwards, making sure that the Battery is latched up by two spring plates, insert Battery in a slanted angle to enter it into the Battery Holder.

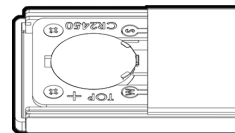
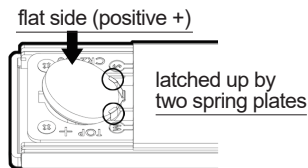

- 2 Completed.

## 5-2 Product Specifications

- Battery:** CR2450 3V (One-time type lithium battery)
- Dimensions:** L 13CM, W 4.8CM, H 1.1CM
- Standby Current:** <1uA
- Modulation Method:** OOK
- Encoding Method:** Internally-burnt fixed coding
- Transmission Frequency:** 433.92MHz
- Antenna Type:** on board, Gain=0 dbi
- Weight (including battery):** 66g



## 5-3 Quick Setting Index

**Travel Distance Setting and Revising:** [OPEN] + [SET]

**Add another Remote Control:** [SET], (Remote Control 2) [Stop]

**Clear off Password:** [Open] + [Stop] + [Close] + any of [Left] or [Right] blank key, [Open] + [Close].

## 5-4 Instructions for using Remote Control Holder

Vertical Holder

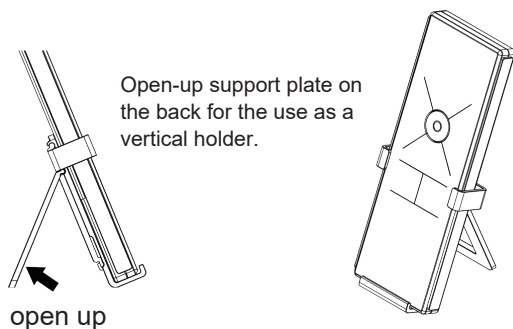

Wall-mount Holder

Apply the provided double-face adhesive tape on the back of Holder and stick it onto the desired position on the wall, as a wall-mounted holder.

Apply the adhesive tape

